



FOR SUBLEASE

523 Park Point Drive, Golden

Suite 320
4,301 RSF

Term: Through April 2027

Rental Rate: \$16.00 / SF FSG

New Furnished Plug n' Play



ANDY CULLEN

PARTNER/MANAGING BROKER

andy@tributaryre.com

720-933-9411

JONA BEHM

VICE PRESIDENT

jona@tributaryre.com

720-394-8694

About The Space....



HIGHLIGHTS

- 10 Offices
- 2 Executive Offices
- 1 Eight Person Conference Room
- 7 Workstations
- Storage/IT
- Kitchen

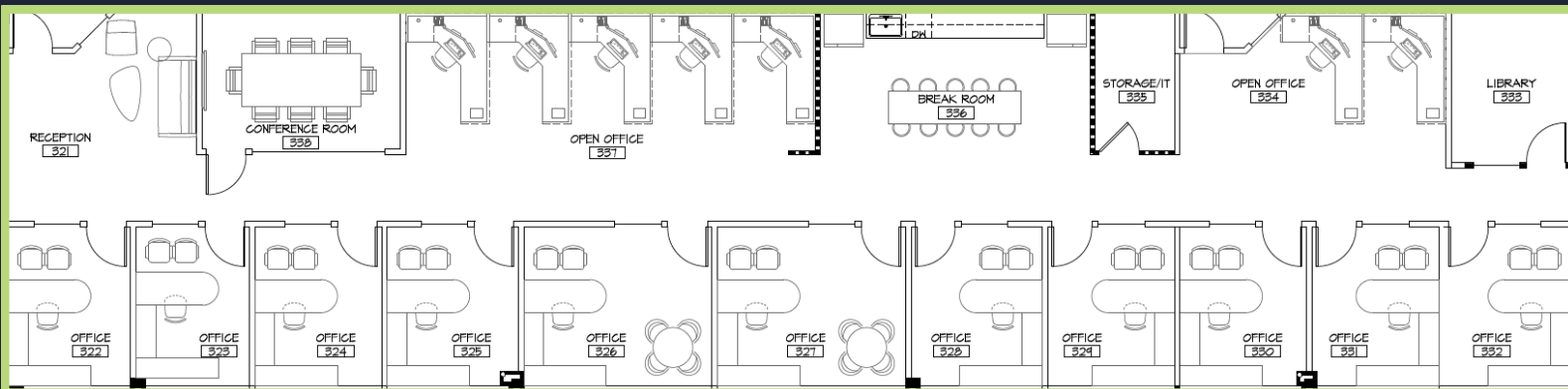

ANDY CULLEN

PARTNER/MANAGING BROKER

andy@tributaryre.com

720-933-9411

JONA BEHM

VICE PRESIDENT

jona@tributaryre.com

720-394-8694



About The Building....



Genesee Point

Genesee Point offers unique design and construction in addition to attached covered parking and on-site storage space. The property is characterized by its nine to ten foot interior ceilings as well as its continuous stretch of windows wrapping the exterior, providing excellent light and views of the foothills. The three story office building was constructed in August of 2000 and features flexible floor plates providing an efficient layout for office space.

Located 23 minutes from downtown Denver.

ANDY CULLEN

PARTNER/MANAGING BROKER
andy@tributaryre.com
720-933-9411

JONA BEHM

VICE PRESIDENT
jona@tributaryre.com
720-394-8694

