



# FOR LEASE

6402 S Troy - Suite 330  
Englewood



## 2,488 RSF

Term: Negotiable

Rental Rate: \$21/SF Gross

Immediate Occupancy

Parking Included

Furniture Included

**AMY ALDRIDGE**

PARTNER

[amy@tributaryre.com](mailto:amy@tributaryre.com)

720-217-7340

# About The Space....



- 2 Private Offices
- 8 Workstations
- Small Kitchenette
- Furniture Available
- Parking 4/1000SF
- Property Manager
- On Site Fitness Center & Showers

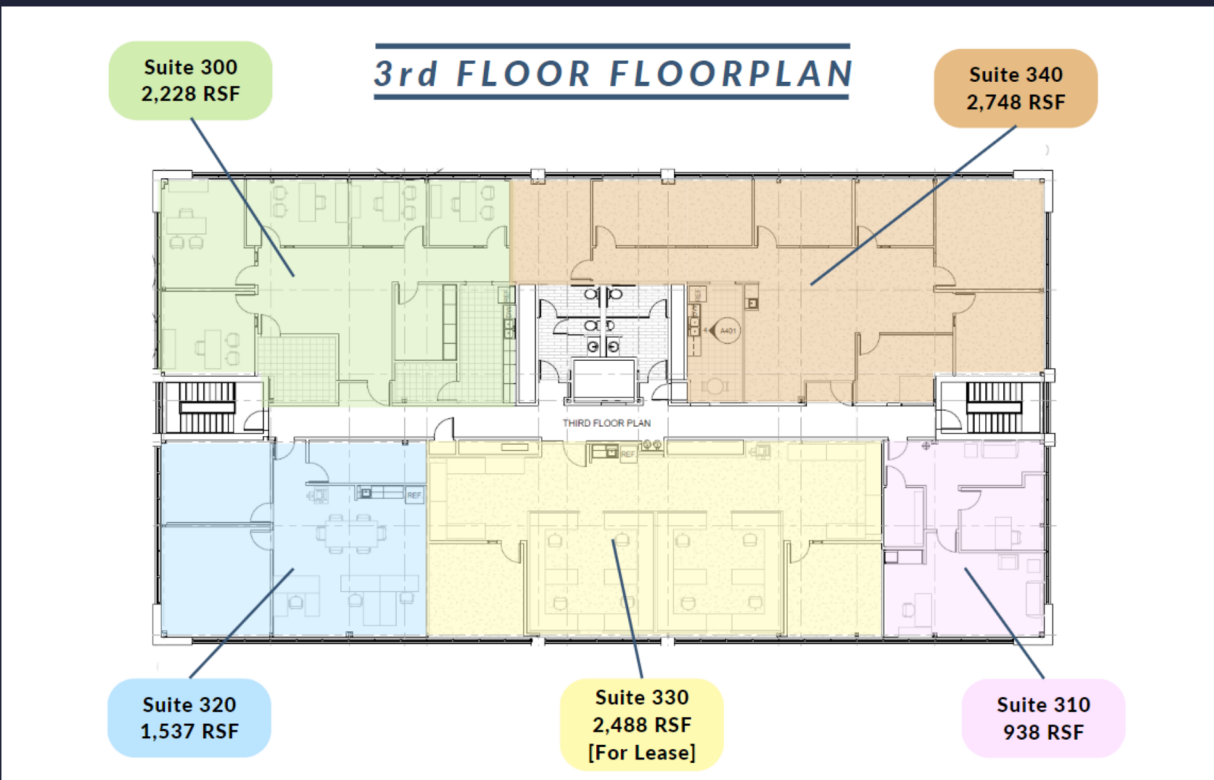

**AMY ALDRIDGE**  
PARTNER  
amy@tributaryre.com  
720-217-7340



# About The Building....



## 6402 SOUTH TROY

6402 S Troy is a Class B office building located in the southeast sector of Denver, Colorado. This three-story brick building offers great occupancy in the heart of the southeast suburban Denver office market. 6402 S Troy is located in close proximity to the Denver Tech Center, one of the area's most dynamic business-oriented developments. It is also within close proximity to I-25 with a plethora of great restaurants and entertainment nearby! DTC has three light rail stops located within the submarket, making it a prime location for transit-oriented development.



**AMY ALDRIDGE**  
PARTNER  
amy@tributaryre.com  
720-217-7340

