



# FOR SUBLEASE

7000 S Yosemite St - Suite 280  
Centennial

## 4,064 RSF

Term: Through March, 2024

Rental Rate: \$16/SF FSG

Immediate Occupancy

Parking Included



**AMY ALDRIDGE**  
PARTNER  
amy@tributaryre.com  
720-217-7340

**MICHAEL HARPOLE**  
SENIOR BROKER  
mike@tributaryre.com  
303-880-8770

# About The Space....

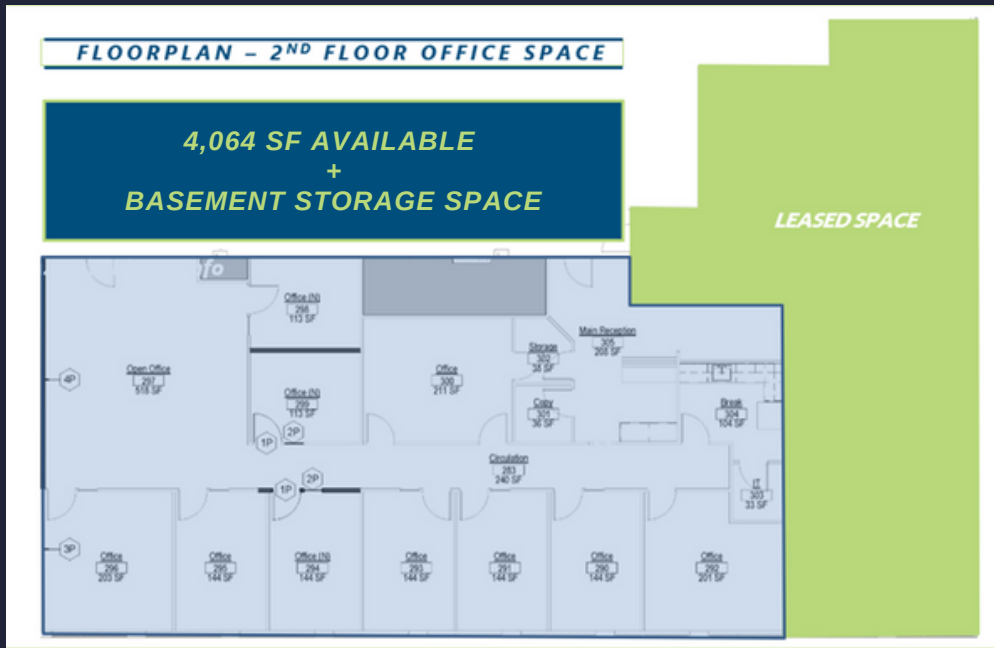

- 8 Private offices
- 2 Executive Offices/Conference rooms
- 8 Workstations
- Kitchenette
- Reception
- Furniture Negotiable
- Basement Storage

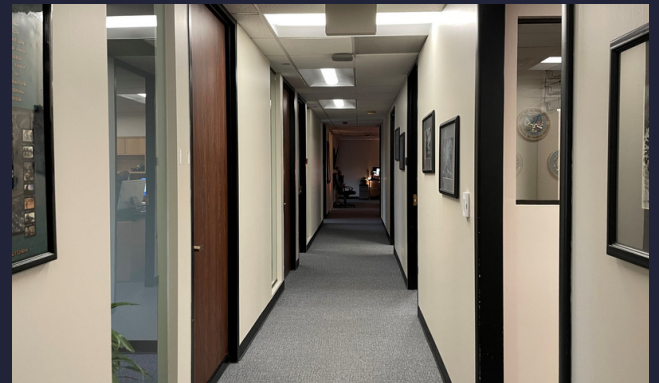

**AMY ALDRIDGE**  
PARTNER  
amy@tributaryre.com  
720-217-7340

**MICHAEL HARPOLE**  
SENIOR BROKER  
mike@tributaryre.com  
303-880-8770



# About The Building....



## 7000 S YOSEMITE

7000 South Yosemite Street is a Class B office building located in the southeast suburbs of Denver, Colorado. This two-story brick building offers great historic occupancy in the heart of the southeast suburban Denver office market. 7000 S Yosemite is located directly adjacent to the Denver Tech Center, one of the area's most dynamic business-oriented developments. It's within close proximity to I-25 with a plethora of great restaurants and entertainment nearby! DTC has three light rail stops located within the submarket, making it a prime location for transit-oriented development.

**AMY ALDRIDGE**  
PARTNER  
amy@tributaryre.com  
720-217-7340

**MICHAEL HARPOLE**  
SENIOR BROKER  
mike@tributaryre.com  
303-880-8770

