



FOR SUBLEASE

7000 S Yosemite St - Suite 280
Centennial

4,064 RSF

Term: Through March, 2024

Rental Rate: \$16/SF FSG

Immediate Occupancy

Parking Included

Green Screen Studio



MICHAEL HARPOLE
SENIOR BROKER
mike@tributaryre.com
303-880-8770

AMY ALDRIDGE
PARTNER
amy@tributaryre.com
720-217-7340

About The Space....

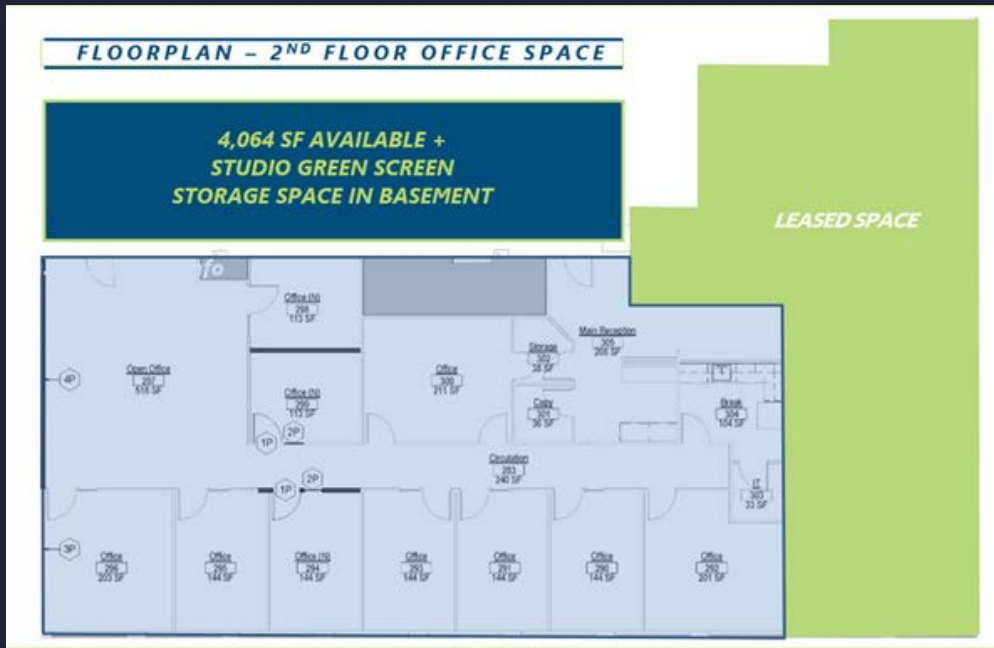

- 8 private offices
- 2 executive offices/conference rooms
- 8 workstations
- 1 kitchenette
- Reception
- Green Screen
- Storage Space
- Furniture Negotiable

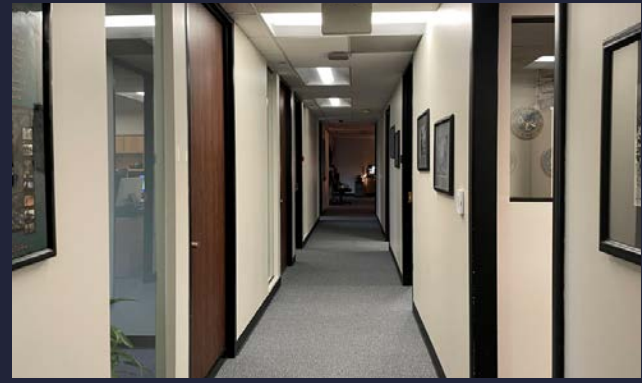

MICHAEL HARPOLE
SENIOR BROKER
mike@tributaryre.com
303-880-8770

AMY ALDRIDGE
PARTNER
amy@tributaryre.com
720-217-7340



About The Building...



7000 S YOSEMITE

7000 South Yosemite Street is a Class B office building located in the southeast suburbs of Denver, Colorado. This two-story brick building offers great historic occupancy in the heart of the southeast suburban Denver office market. 7000 S Yosemite is located directly adjacent to the Denver Tech Center, one of the area's most dynamic business-oriented developments. It's within close proximity to I-25 with a plethora of great restaurants and entertainment nearby! DTC has three light rail stops located within the submarket, making it a prime location for transit-oriented development.

MICHAEL HARPOLE

SENIOR BROKER

mike@tributaryre.com

303-880-8770

AMY ALDRIDGE

PARTNER

amy@tributaryre.com

720-217-7340

