

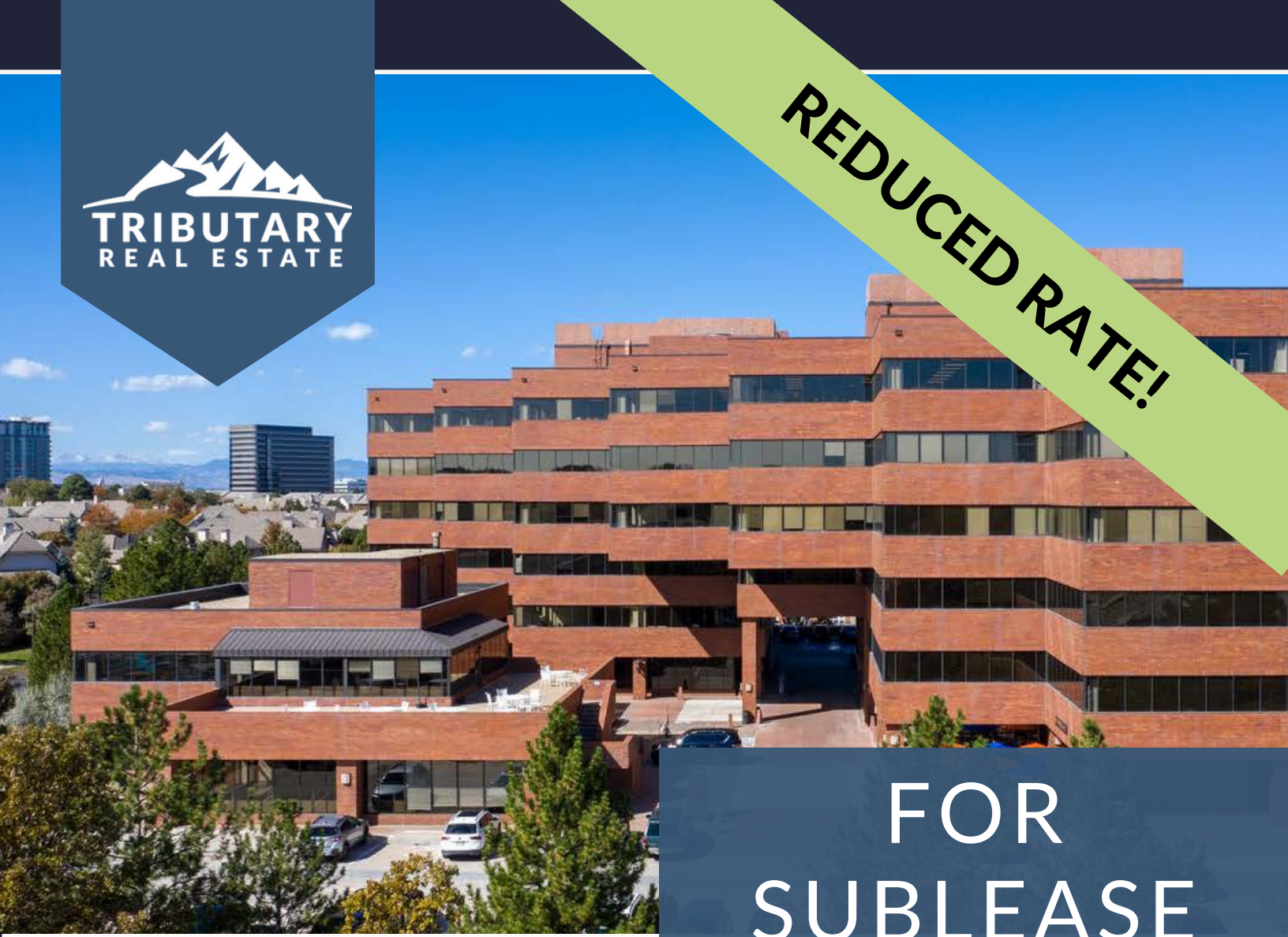

**REDUCED RATE!**



# FOR SUBLEASE

5690 DTC Blvd, Suite 515E-540E  
Greenwood Village

**2,708-10,377 RSF**

Term: Through Dec, 2024

Rental Rate: ~~\$20/SF FSG~~

\$15/SF FSG

Parking Included

Immediate Occupancy



**AMY ALDRIDGE**

PARTNER

amy@tributaryre.com

720-217-7340

**MICHAEL HARPOLE**

SENIOR BROKER

mike@tributaryre.com

303-880-8770

# About The Space....

Suites 515E and 540E can be leased together or separately. They are connected by a secured internal entrance, and both suites have a private entrance / exit to the main building corridor.

## FLOORPLAN

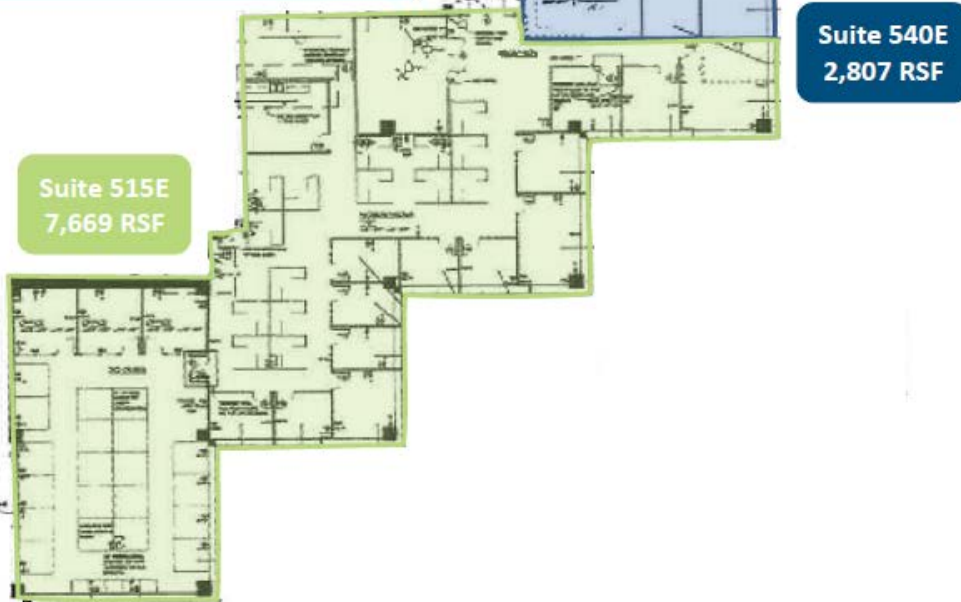

- 20 offices
- 1 executive offices
- 3 small conference room
- 1 large conference room
- 41 workstations
- 1 IT Room
- 1 Breakroom
- 1 Kitchen
- Reception
- Furniture negotiable
- Parking: 3.50/1,000
- Common conference room
- Exercise facility
- Showers & lockers



**AMY ALDRIDGE**  
PARTNER  
amy@tributaryre.com  
720-217-7340

**MICHAEL HARPOLE**  
SENIOR BROKER  
mike@tributaryre.com  
303-880-8770



# About The Building...



## PARK PLACE

Park Place features recently upgraded common areas including the elevator lobbies, corridors, and restrooms. Park Place includes many amenities. Among these amenities are a Building Conference Room, Exercise Facilities with Showers and Lockers, and on-site deli serving breakfast, lunch, and snacks throughout the day. Parking at Park Place is located under the building to protect tenants and visitors from the elements. Park Place is located in close proximity to area hotels including the Hyatt Regency and Marriott DTC as well as dozens of restaurants throughout the Denver Tech Center and along Arapahoe Road. This property offers Rocky Mountain views and extensive landscaping. Further amenities include available fiber optics, evening security patrols, card-key access and janitorial services. On-site storage is also available. Approximately 3.0/1000 of the parking spaces are covered.

**AMY ALDRIDGE**  
PARTNER  
amy@tributaryre.com  
720-217-7340

**MICHAEL HARPOLE**  
SENIOR BROKER  
mike@tributaryre.com  
303-880-8770

